

DLF-62W

6" NON-IC Housing with Lensed Wall Wash Trims For
(1) or (2) DTT/TTT Lamps

Catalog #		Type
Project		Date
Prepared by		

FLUORESCENT

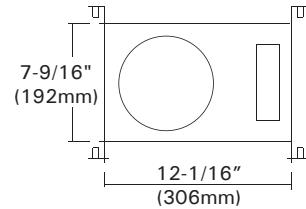
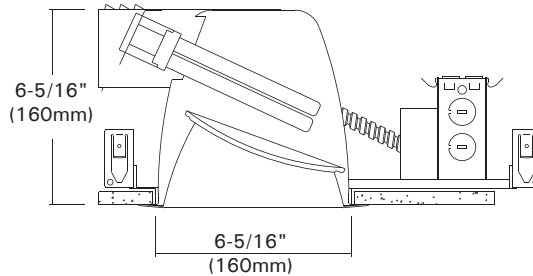

DESCRIPTION

The 6" aperture smooth wall wash housings for (1) or (2) horizontal CFL lamps. Angled spread lens and haze clear slope cone give visual comfort in round circulation areas.

DESIGN FEATURES

• Mounting Frame

- Galvanized steel construction.
- Housing adjusts for ceilings up to 1-1/4" thick.

• Junction Box

- Listed for through branch circuit wiring.(Max.8 No 12 AWG 90°C branch circuit conductors. (4 in, 4 out)
- (5)1/2" knockouts with true pry-out slots and (4) knockouts with Romex cable clamp.
- Ground wire provided on J-box.

• Reflector

- Haze clear slope reflector with sloped lens inserted in a anodized clear, full rereflector.

• Optics

- Directional prismatic spread lens for direct light across or down the wall.

• Trim Ring

- Self flanged matte white or polished chrome.

• Socket

- G24Q/GX24Q socket for use 4 pin DTT, TTT lamps.

• Socket Housing

- Installed declined lampholders in socket housing attached on the reflector top.

• Bar Hangers

- 24" Bar Hangers provide stability and support on joists and T-Bar Grid ceilings.
- Housing can be positioned at any point within 24" joist span.
- Score lines allow "toolless" shortening for 12" joists. Bar hangers may be repositioned 90 degrees.
- Integral T-bar clips snaps onto T-bars and no additional clips are required.

• Lamp

- Compact Fluorescent lamps.
- * DTT-Double twin tube (Quad/CFQ)
 - (1) or (2) 13W DTT (4 pin)
 - (1) or (2) 18W DTT (4 pin)
 - (1) or (2) 26W DTT (4 pin)
- * TTT-Triple Twin Tube (CFTR)
 - (1) 26W TTT (4 pin)
 - (1) 32W TTT (4 pin)

• Ballast

- Class P Thermally protected by internal fuse (3 amp fast blow), Multi-volt electronic ballast or thermal cut-out switch in magnetic ballast.
- High Power Factor Multi-volt Electronic ballasts for 4 pin type compact fluorescent lamps mounted on J-box door for easy access from inside of fixture.

* Listing

- UL, c-UL listed for damp location.
- UL, c-UL listed for feed through.

• Just-A-Nail

Adjustable nail hanger bar for easy alignment.

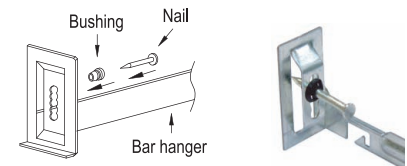

JUST-A-NAIL

- Pre-installed nail bars with vertical slots are used to evenly align the bars horizontally after nailing halfway into wood joists.

• Optional "Quick Connect" Push-in wire connectors.

- Three "Quick Connectors"
- Pre-installed push-in wire connectors for fast and easy wiring.

Ordering Information

Housing	Ballast	Lamp(s) Watt.	Option
DLF-62W	-N : 120V NPF Magnetic -H : 120V HPF Magnetic -NE : 120V NPF Electronic -HE : 120V HPF Electronic -E : 120V/277V HPF Electronic	113 : (1)13W 213 : (2)13W 118 : (1)18W 218 : (2)18W 126 : (1)26W 226 : (2)26W 132 : (1)32W	-EM : Emergency w/ Remote Test Switch -C : Quick Connectors

Example : DLF-62W-E226

Trims

6", 8" Sloped Lens Wall Wash Housing Trims For DLF-62W

Catalog #		Type
Project		Date
Prepared by		

FLUORESCENT

TM-669BG

Reflector Assembled with
Sloped Baffle w/ Convex
Prismatic Lens
2x26W DTT, 1x32W TTT

White Metal Trim Ring
O.D : 7-1/4"

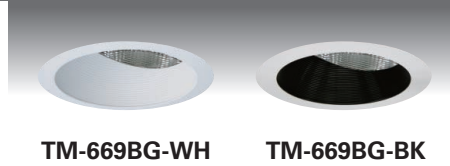

TM-669BG-WH

TM-669BG-BK

TM-669RG

Reflector Assembled with
Sloped Reflector w/ Convex
Prismatic Lens
2x26W DTT, 1x32W TTT

White Metal Trim Ring
O.D : 7-1/4"

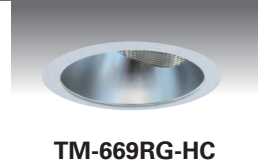

TM-669RG-HC

INNER WALL WASH TRIMS

TM-625BG

One Piece Sloped Baffle
w/ Convex Prismatic Lens
2x26W DTT, 1x32W TTT

White Metal Trim Ring
O.D : 7-1/4"

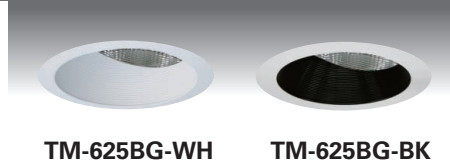

TM-625BG-WH

TM-625BG-BK

TM-625RG

One Piece Sloped Reflector
w/ Convex Prismatic Lens
2x26W DTT, 1x32W TTT

White Metal Trim Ring
O.D : 7-1/4"

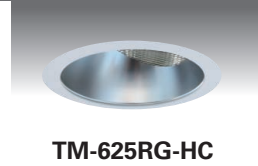

TM-625RG-HC

Trims For DLF-82W

TM-889BG

Reflector Assembled with
Sloped Baffle w/ Convex
Prismatic Lens
2x42W TTT, 1x42W TTT

White Metal Trim Ring
O.D : 8-7/8"

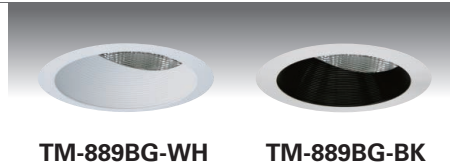

TM-889BG-WH

TM-889BG-BK

TM-889RG

Reflector Assembled with
Sloped Reflector w/ Convex
Prismatic Lens
2x42W TTT, 1x42W TTT

White Metal Trim Ring
O.D : 8-7/8"

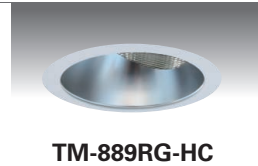

TM-889RG-HC

INNER WALL WASH TRIMS

TM-825BG

One Piece Sloped Baffle
w/ Convex Prismatic Lens
2x42W TTT, 1x42W TTT

White Metal Trim Ring
O.D : 8-7/8"

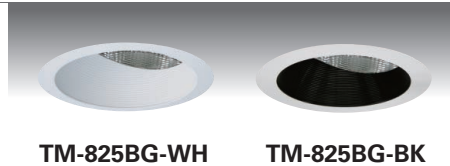

TM-825BG-WH

TM-825BG-BK

TM-825RG

One Piece Sloped Reflector
w/ Convex Prismatic Lens
2x42W TTT, 1x42W TTT

White Metal Trim Ring
O.D : 8-7/8"

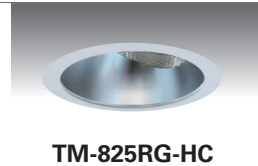

TM-825RG-HC

ORDERING INFORMATION

Choose the catalog / finish codes that best suit your needs and enter it on the appropriate line.

TRIM MODEL	REFLECTOR	LENS	BAFFLE	METAL RING
	CL :Clear	FR :Fresnel	WH :White	WH :White
	WH :White	AS :All Sanded	BK :Black	BK :Black
	GD :Gold	CL :Clear	SN :Satin Nickel	SN :Satin Nickel
	MA :Matte Platinum	CV :Convex Prismatic	AN :Antique Nickel	AN :Antique Nickel
	CP :Champagne	AL :Albalite	AC :Antique Copper	AC :Antique Copper
	PR :Pewter		MO :Mocha	MO :Mocha
	HC :Haze Clear		CA :Cappuccino	CA :Cappuccino
			CH :Chrome	CH :Chrome
			UN :Natural Steel	UN :Natural Steel
			PB :Polished Brass	PB :Polished Brass

Examples:

TM-669BG-BK-WH = White Trim Ring w/ Sloped Black Baffle

TM-669RG-CL-WH = White Trim Ring w/ Sloped Clear Reflector